

SUNSEEKER 52 PREDATOR . 2009

Lying: AJACCIO

650 000 TTC



2009 yachts, great shape

Black hull
Hydraulique platform

options :
hard top
gangway Besenzoni
air conditionning
crew cabin
sun bath
ice maker
teak in the saloon
stern thruster
electrical sunblind
winch
anchor winch superior
cover for cushion
cockpit table extended

Contact: Jean Christophe SANTARELLI

Gsm: +33 (0)6.24.92.31.55 - Tel: +33 (0)4.95.22.64.21

Email: santarelli.marine@wanadoo.fr

SUNSEEKER 52 PREDATOR . 2009

Dimensions::

- Length: 17.60 m
- Width: 4.63 m
- Draught: 1.26 m
- Displacement :24,800 T

Propulsion:

- 2 moteur(s) DIESEL VOLVO D12-800 775 cv 129 h
- Transmission: ligne d'arbre
- Fuel capacity: 2140 l
- Water capacity: 625 l
- Generator: ONAN 11.5Kw

Contact: Jean Christophe SANTARELLI

Gsm: +33 (0)6.24.92.31.55 - Tel: +33 (0)4.95.22.64.21

Email: santarelli.marine@wanadoo.fr

SUNSEEKER 52 PREDATOR . 2009

Pont

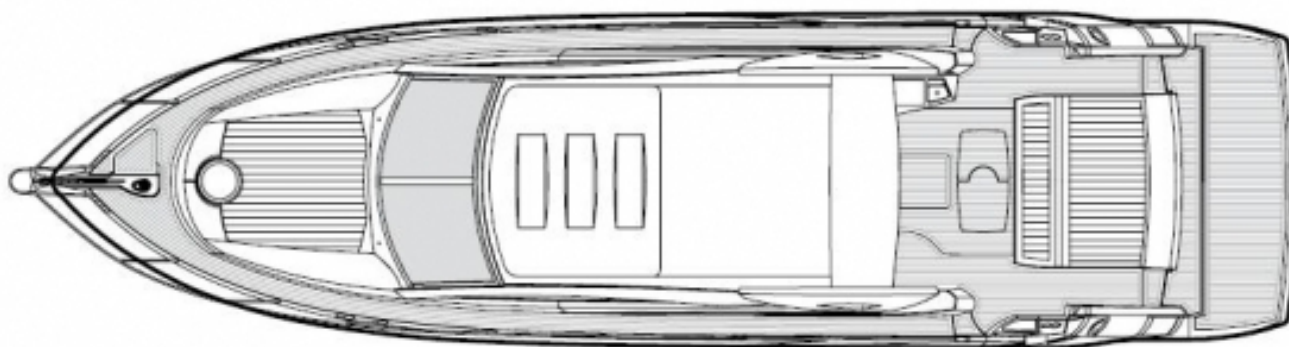

Pont principal

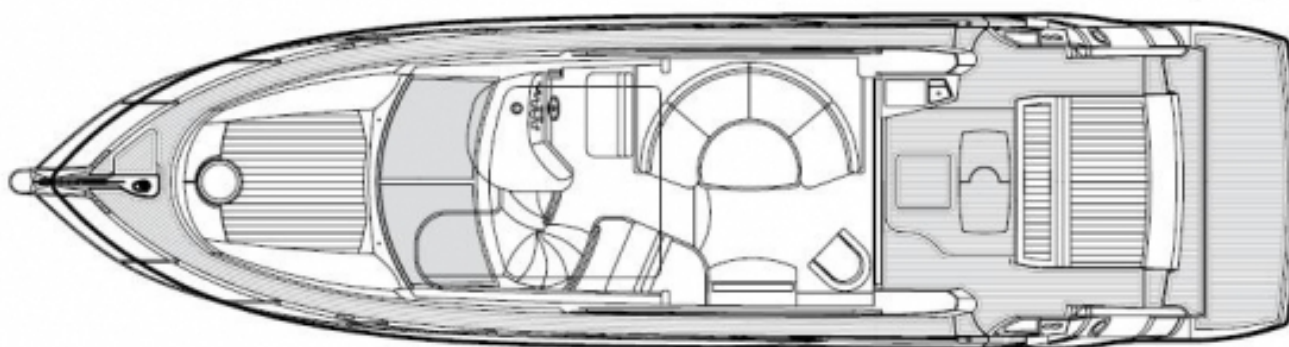

Pont inférieur

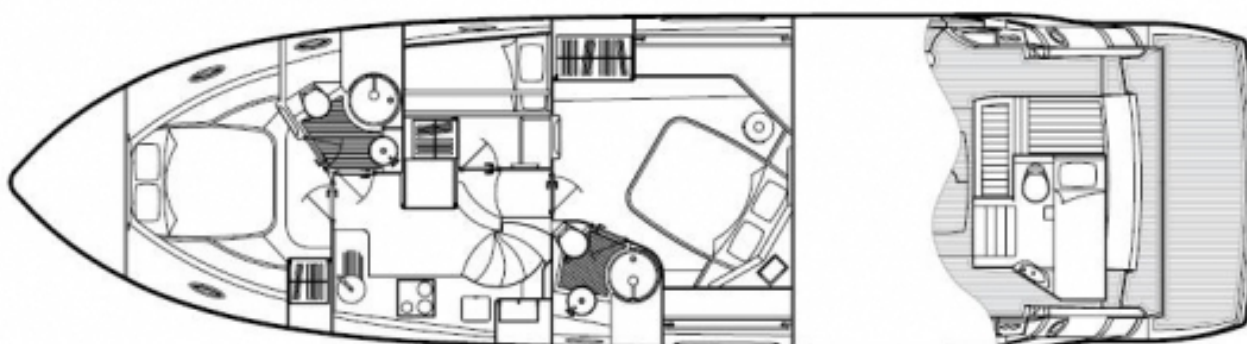

Contact: Jean Christophe SANTARELLI

Gsm: +33 (0)6.24.92.31.55 - Tel: +33 (0)4.95.22.64.21

Email: santarelli.marine@wanadoo.fr